

















# LEGEND

- DISTRICT BOUNDRY 
- DISTRICT HEAD QUARTER 
- TEHSIL BOUNDRY 
- TEHSIL HEAD QUARTER 
- MARKIZ BOUNDRY 
- MARKIZ HEADQUARTER 
- UNION COUNCIL HEAD QUARTER 
- MAIN TOWNS IN SAHIWAL,
  - ≤ 10,000 
  - 10,000 — 25,000 
  - 25,000 — 50,000 
  - 50,000 — 1,00,000 
  - 1,00,000 > 
- HIGHWAY DEPARTMENT
  - METALLED ROAD 
  - UNMETALLED ROAD 
- OTHER DEPART. UNMETALLED ROAD 
- RAILWAY LINES 
- RIVER 
- KUCHA PATH 

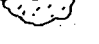
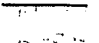
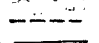

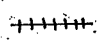
- PARAPET
- MUD PLASTER & COWDUNG FINISH 1"
- EARTH 4"
- DUB (GRASS)
- SARKANDA MATTING
- SIRKE MATTING
- ACACIA BATTENS 2½" x 3" x 6'
- ACACIA BEAM 4" x 8" x 14'
- SUN-BAKED BRICK WALL 15½" IN MUD MORTAR
- MUD-STRAW PLASTER 1"

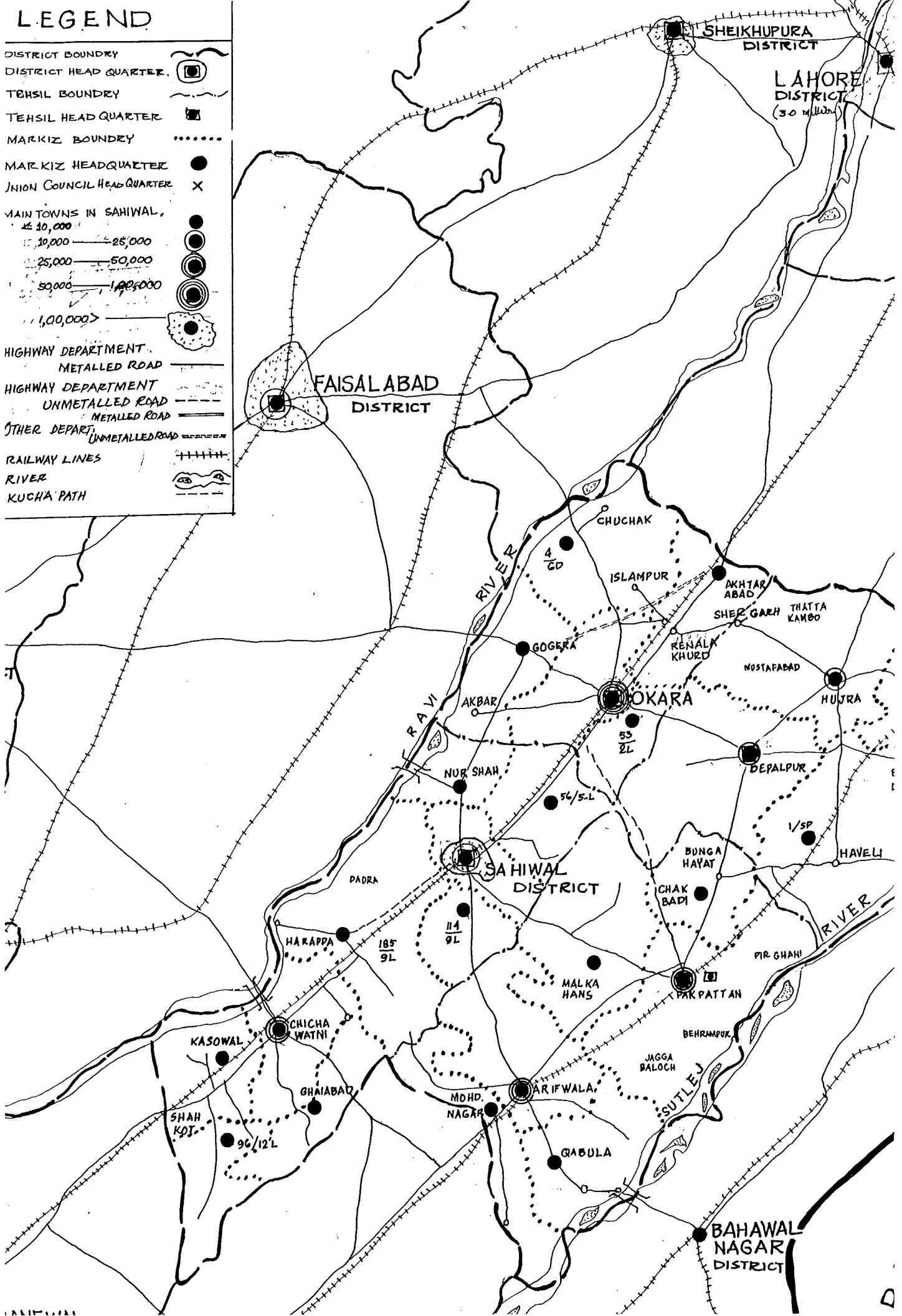
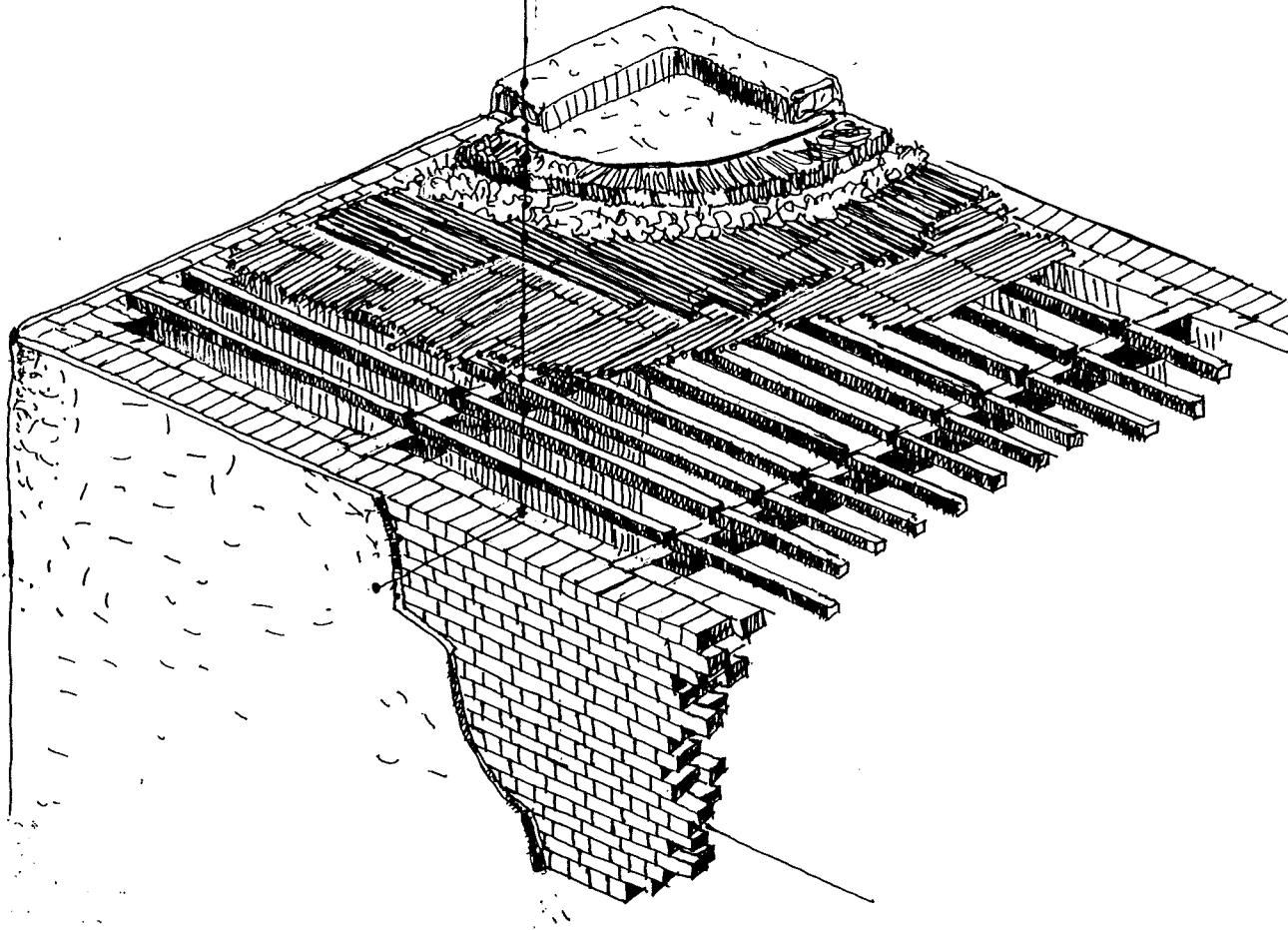

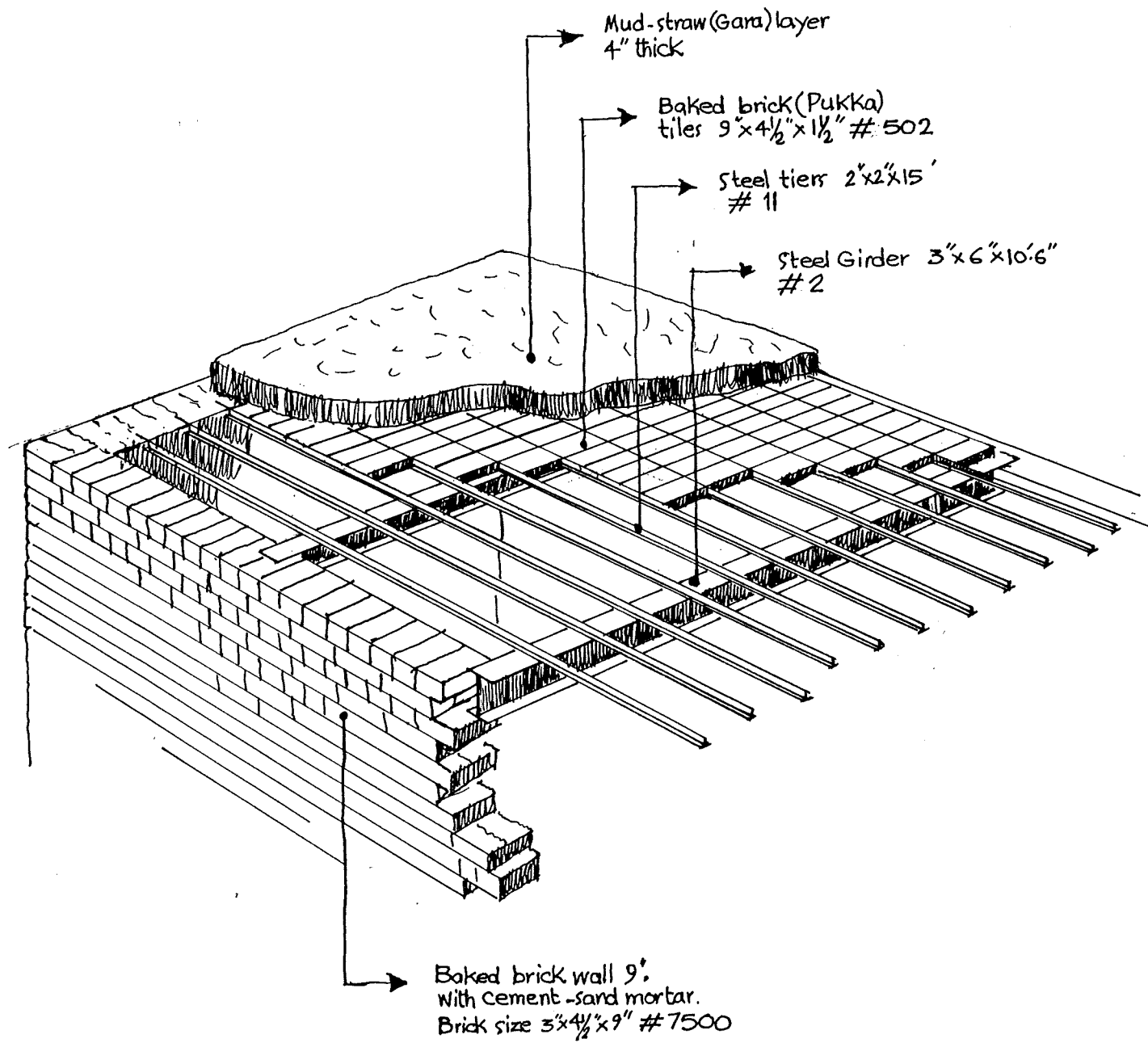
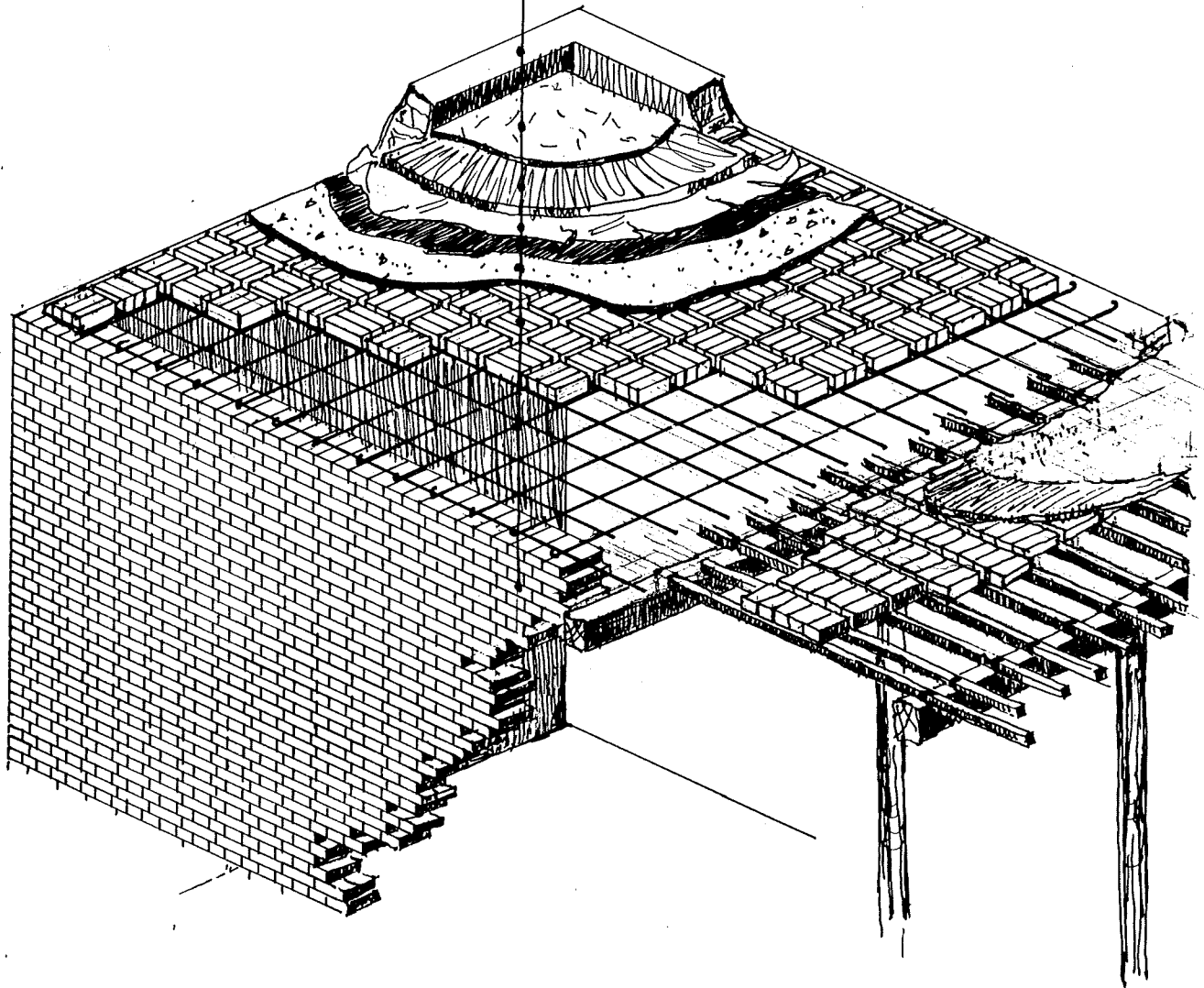
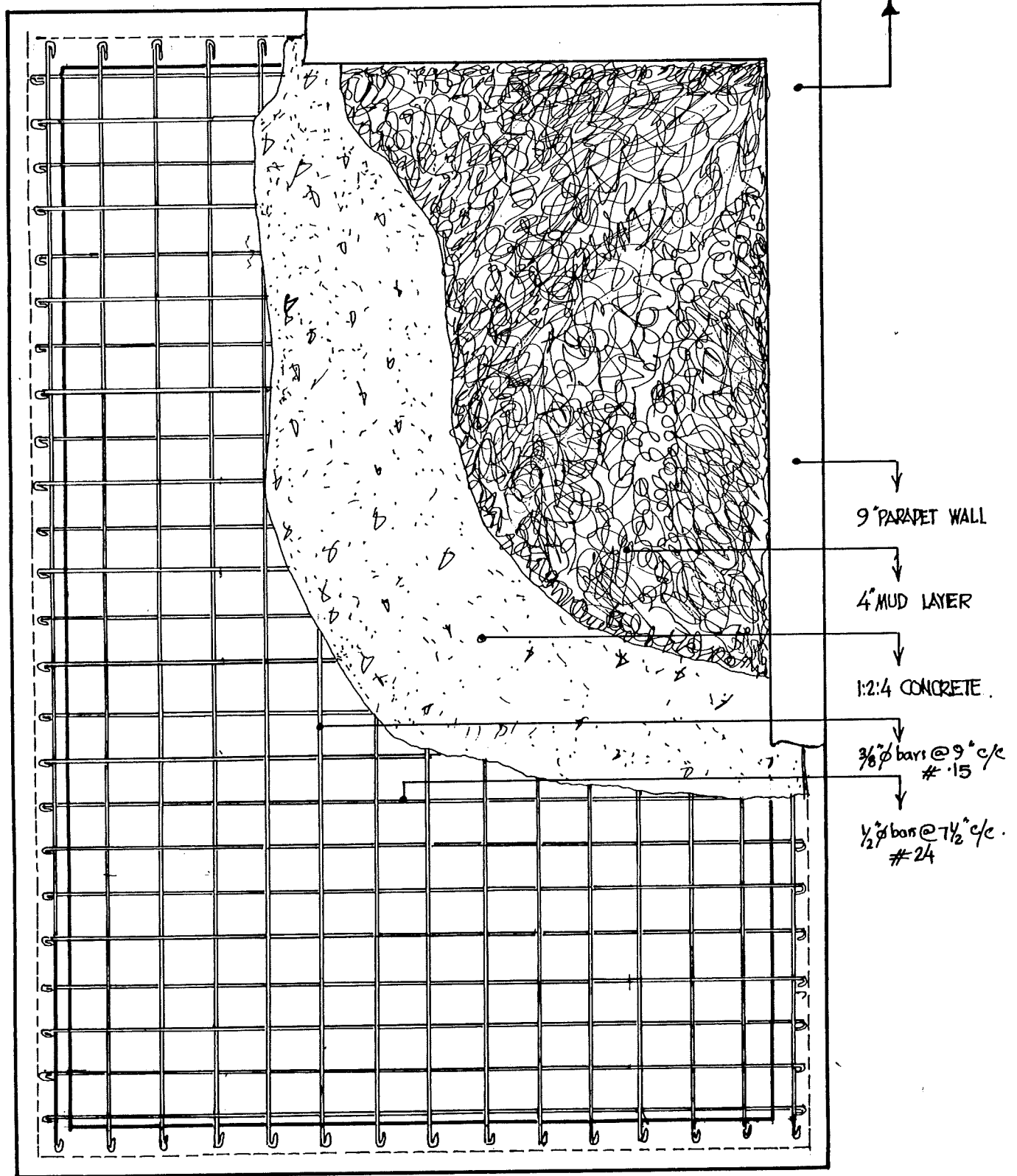
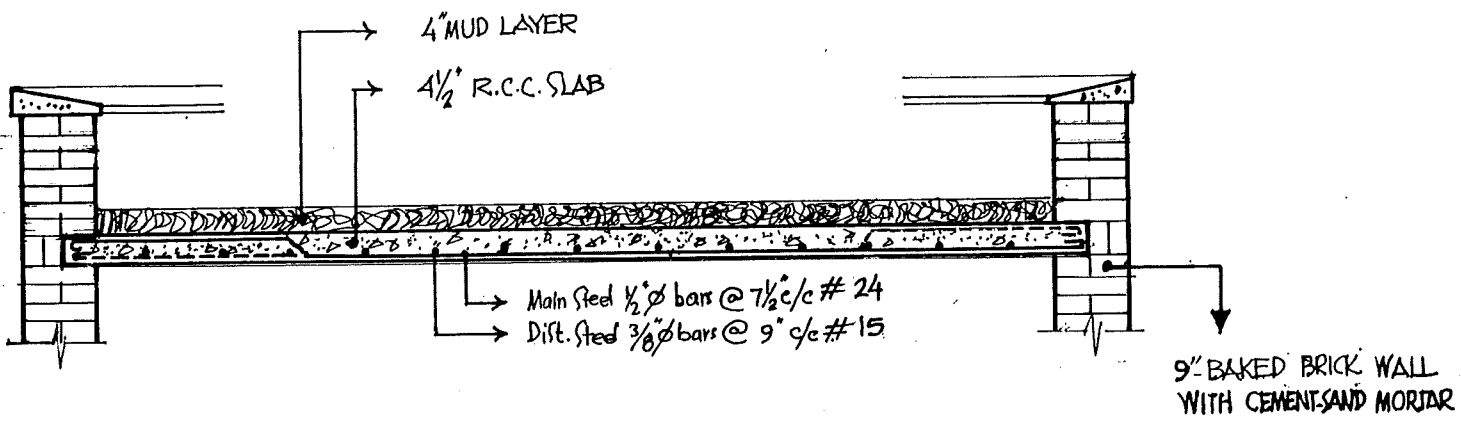

Fig.3:2:2: PUKKA-KUTCHA TECHNOLOGY TYPE 2

- PARAPET
- MUD STRAW PLASTER 1/2"
- EARTH 2 1/2"
- POLYTHENE 0.5 GAUGE
- BITUMEN 2 COATS
- CEMENT : SAND : AGGR. (1 : 3 : 4)
- FIRED BRICK TRIO
- M.S. BARS 1/2" φ @ 11 1/2" c/c
- FIRED BRICK WALL IN C : S MORTAR





- 8"x4" ACCACIA BEAM (14' LENGTH)
- 3"x2" ACCACIA BATTENS (6' LENGTH)
- 1 LAYER SIRKEE
- 1 LAYER SARKANDA MATTING
- 4" EARTH
- 1" MUD PLASTER & COW DUNG FINISH

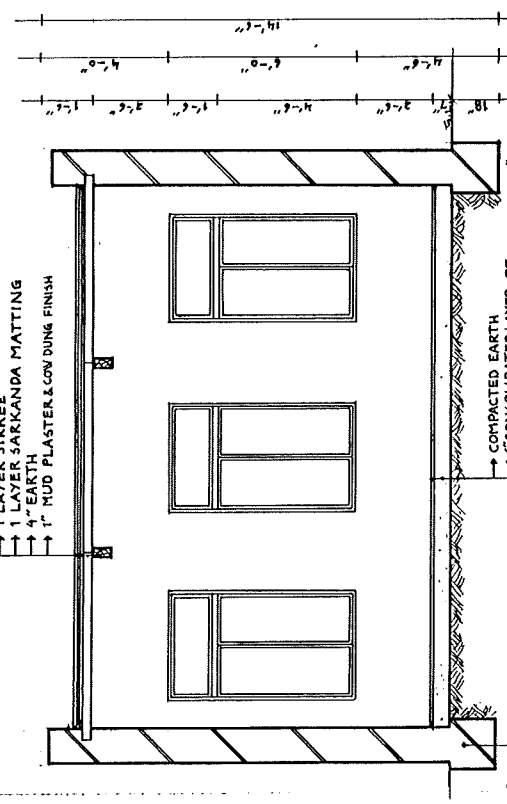

- COMPACTED EARTH
- 6" CONSOLIDATED LAYER OF MOISTENED EARTH RAMMED.
- 1" MUD PLASTER & COW DUNG FINISH

- 8"x4" ACCACIA BEAM (14' L)
- 3"x2" ACCACIA BATTENS
- 1 LAYER SIRKEE
- 1 LAYER SARKANDA MATTING
- 4" EARTH
- 1" MUD PLASTER & COW DUNG FINISH.

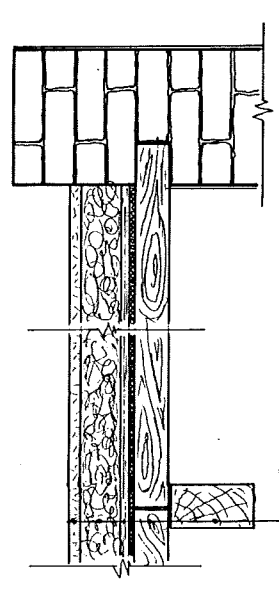
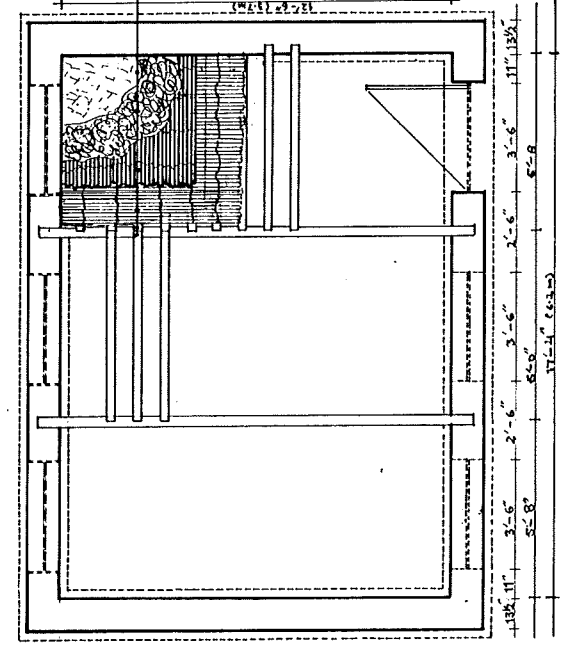

- 8"x4" ACCACIA BEAM (14' LENGTH)
- 3"x2" ACCACIA BATTENS (6' LENGTH)
- 1 LAYER SIRKEE
- 1 LAYER SARKANDA MATTING
- 4" EARTH
- 1" MUD PLASTER & COW DUNG FINISH

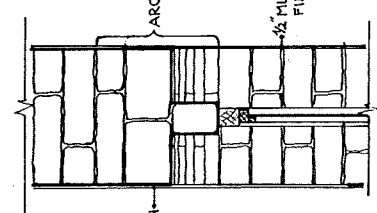

- 1/2" MUD PLASTER & COW DUNG FINISH
- ARCHED LINTEL
- 1/2" MUD PLASTER & COW DUNG FINISH

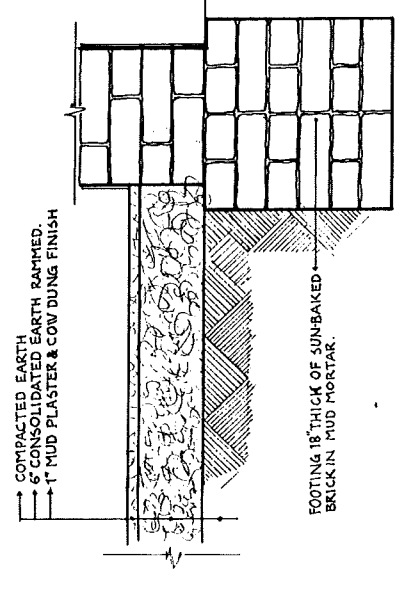

- COMPACTED EARTH
- 6" CONSOLIDATED EARTH RAMMED.
- 1" MUD PLASTER & COW DUNG FINISH

- FOOTING 18" THICK OF SUN-BAKED BRICK IN MUD MORTAR.

# 4.2. DISTRIBUTION OF CONSTRUCTION EXPENDITURE SPATIALLY & BETWEEN INCOME GROUPS.

## COMPARING BUILDING TECHNOLOGIES.

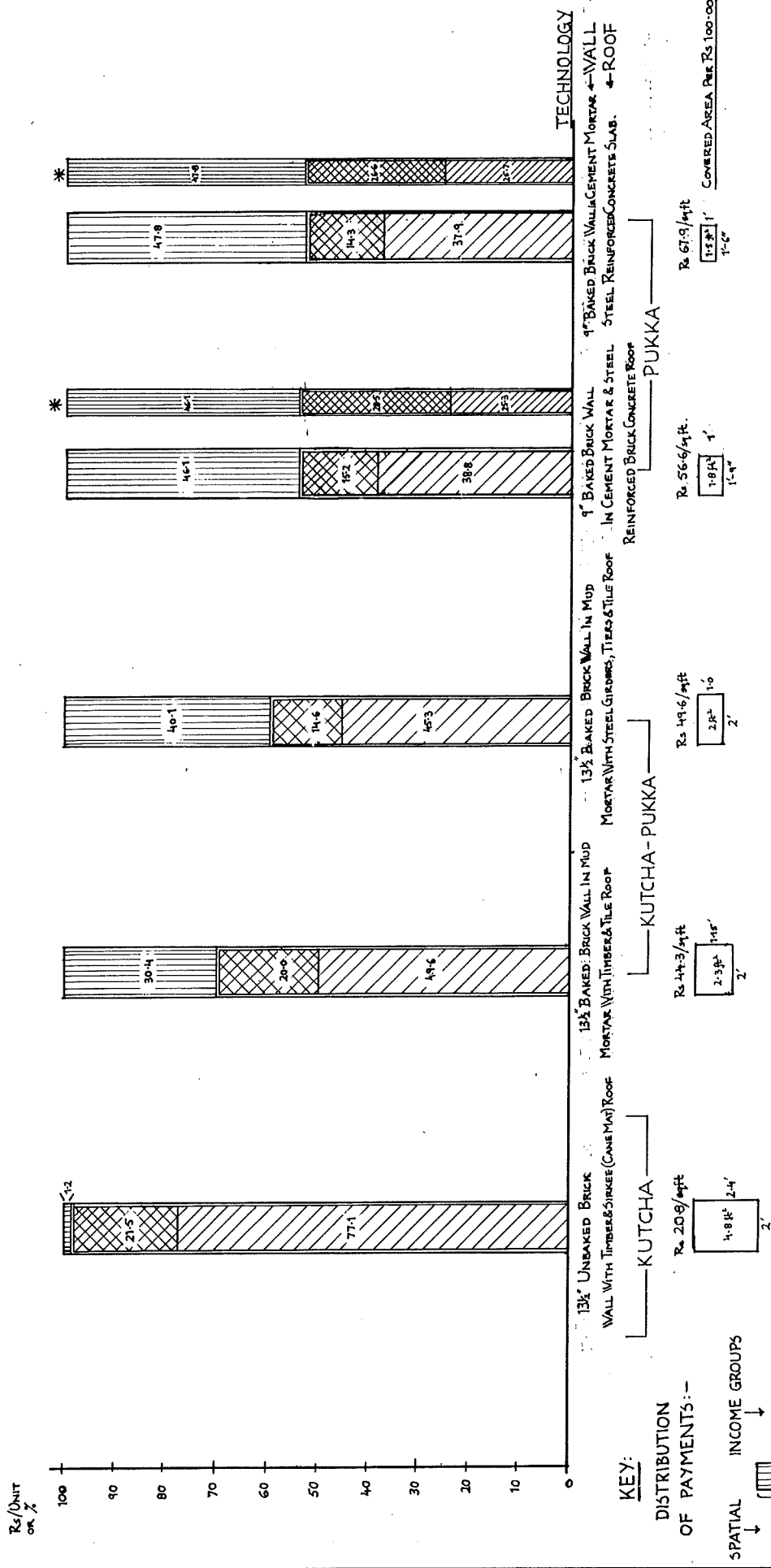

KEY: DISTRIBUTION OF PAYMENTS :-  
 SPATIAL INCOME GROUPS  
 EXTERNAL (TO REGION)  
 LOCAL (WITHIN REGION)  
 PROPRIETORS (UPPER INCOME)  
 WORKERS (LOWER INCOME)

COMMENTS: \* ASSUMING SKILLED WORKERS-CONTRACTORS, MASONS, SMITHS, CARPENTERS ARE IN THE UPPER INCOME GROUP.

4.3

DISTRIBUTION OF CONSTRUCTION EXPENDITURE BETWEEN BUILDING WORKERS & BUILDING MAT. INDUSTRY.

COMPARING BUILDING TECHNOLOGIES.

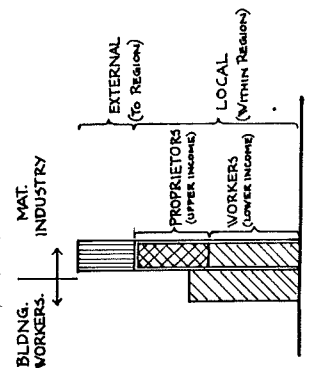
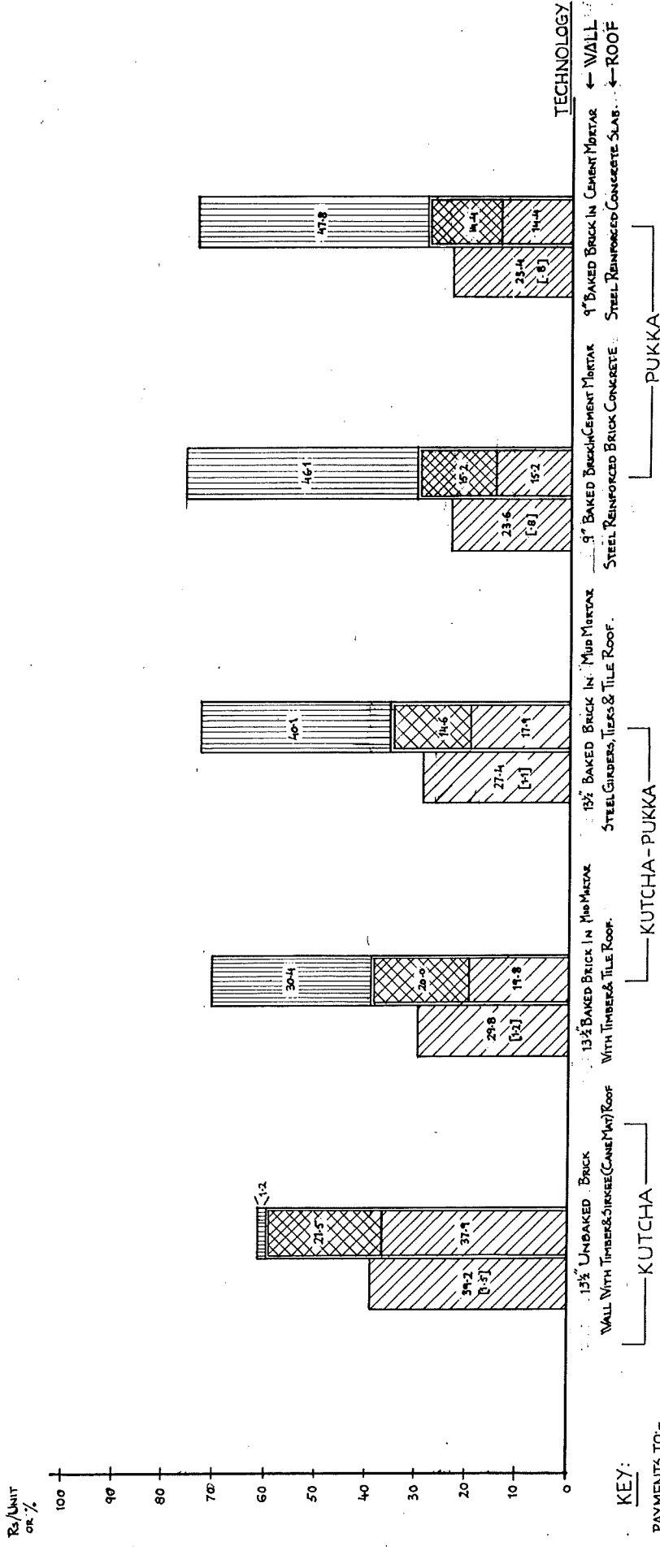
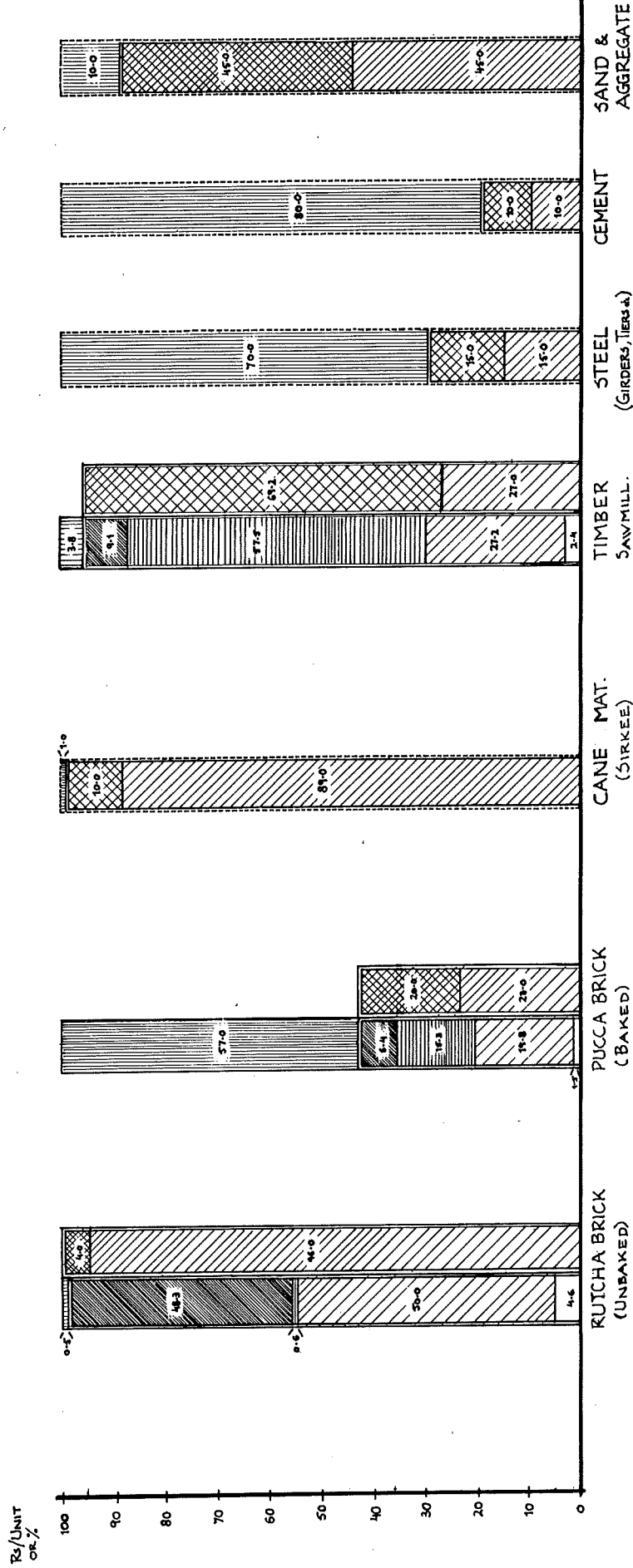

FIGURE IN [ ] NOTES THE MAN-DAYS OF EMPLOYMENT IN CONSTRUCTION PER Rs 100/- OF EXPENDITURE.

COMMENTS:

# 4.1. DISTRIBUTION OF RECEIPTS IN BUILDING MATERIALS INDUSTRIES. (SPATIALLY, BETWEEN INPUTS & INCOME GROUPS)



KEY: DISTRIBUTION OF RECEIPTS AS PAYMENTS TO:-

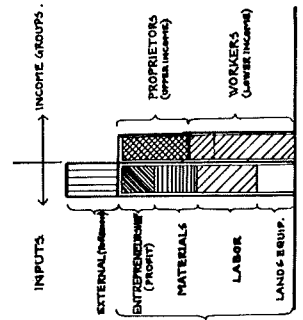

L O C A L

COMMENTS:

CALCULATED FROM INFORMATION ON LOCATION, INPUT COSTS & REVENUE FIGURES GIVEN BY INDUSTRY PROPRIETORS.