

Development Workshop

Box 133
238 Davenport Road
Toronto, Ontario
Canada M5R 1J8

project

client

EXPERIMENTAL HOUSING UNIT,
Gourna, Egypt.

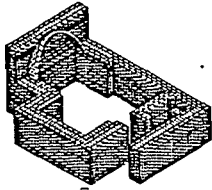

Vault building with centers leaving inward and out wall so that no firm work or shoring is needed.

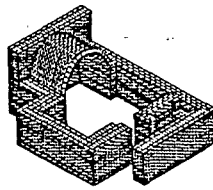

Vault is completed; each corner of bricks is less inward, and work is finished with side walls.

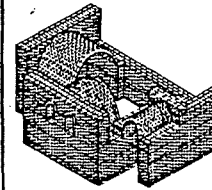

Small vault built in same way as large ones. Loose bricks removed from window opening.

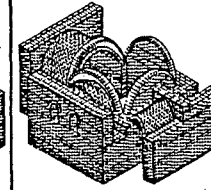

Circular arches built over vaults to form a base for the dome.

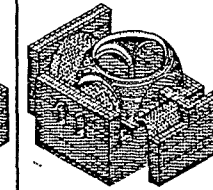

Perimeter completed, forming continuous course from which dome can be completed.



In 1973, Development Workshop designed and constructed an experimental housing unit at New Gourna, Upper Egypt, in the village built by Hassan Fathy.

The house was built with locally produced mud bricks and roofed with vaults and a dome. The programme provided an opportunity to investigate vault and dome roofing configurations. Team training and construction was done with the assistance of Nubian master masons.

Development Workshop

Box 133
238 Davenport Road
Toronto, Ontario
Canada M5R 1J6

project

URBAN PLANNING STUDY:
Old Cairo, Egypt.

client

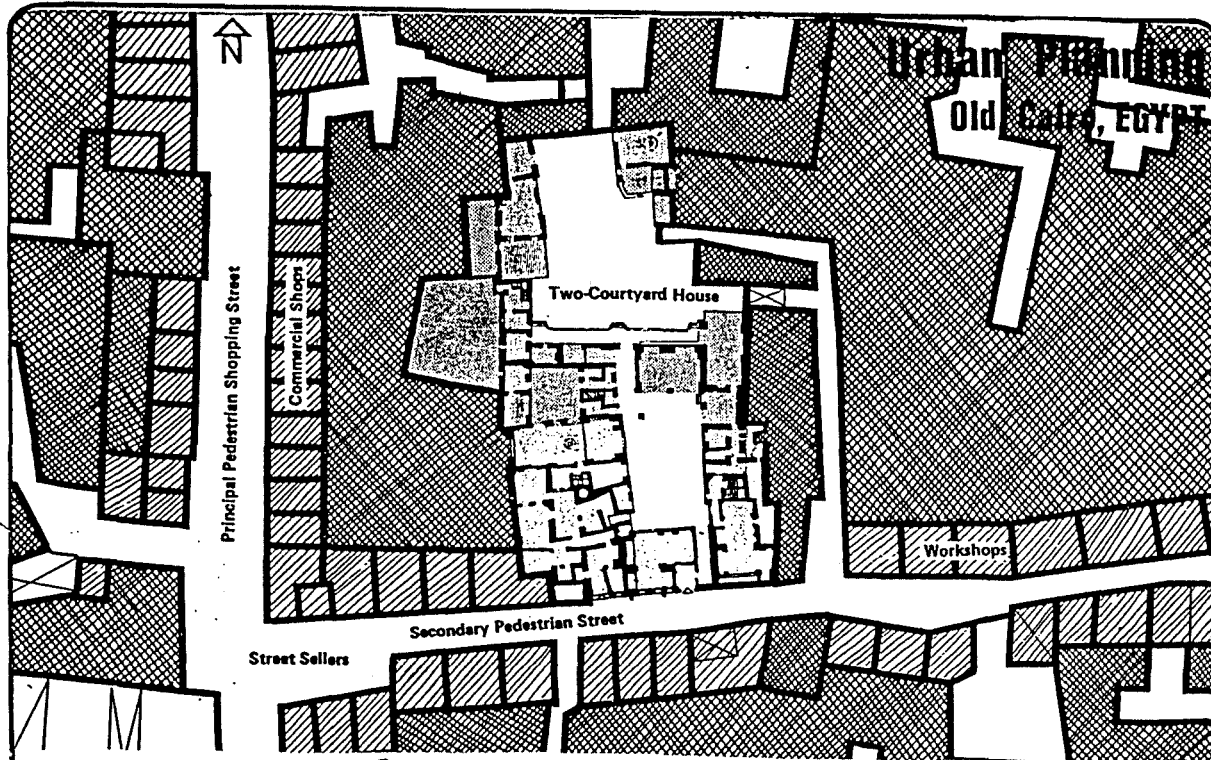

Urban Planning
Old Cairo, EGYPT

Detailed examination of traditional city centres, such as Cairo, Delhi or Yazd, provides a guide to dealing with some of the urban planning problems now faced in III world cities. Studies carried out by Development Workshop in Cairo showed a layout of streets and blocks which provided a sound response to local economic, social, and environmental conditions.

Functions and related spaces are placed in a hierarchy. From municipal squares bounded by higher educational or religious buildings, wide commercial streets run along a north/south axis. Here are the community facilities and shops. The north/south axis ensures shade to the wide street. Narrow east/west streets lead off the principal routes and contain workshops and specialist trades, backed by residential areas.

A juxtaposition of sunny open space and shaded street encourages the ventilation of the streets because of air-pressure differences.

Planning in the past allows centres like these to continue functioning, despite often over-crowded conditions.

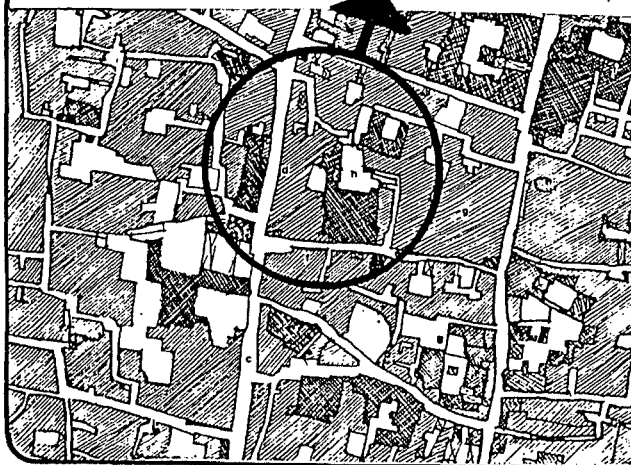

OLD CAIRO

AREA AROUND SUHEMI HOUSE

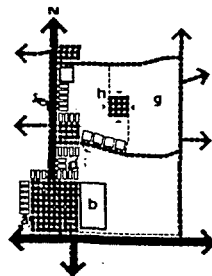

Schematic Plan of Old Cairo

- a) Municipal Square
- b) Public Buildings
- c) Pedestrian Shopping Street
- d) Shops
- e) Secondary Pedestrian Streets
- f) Workshops
- g) Residential Area
- h) Private Courtyard